

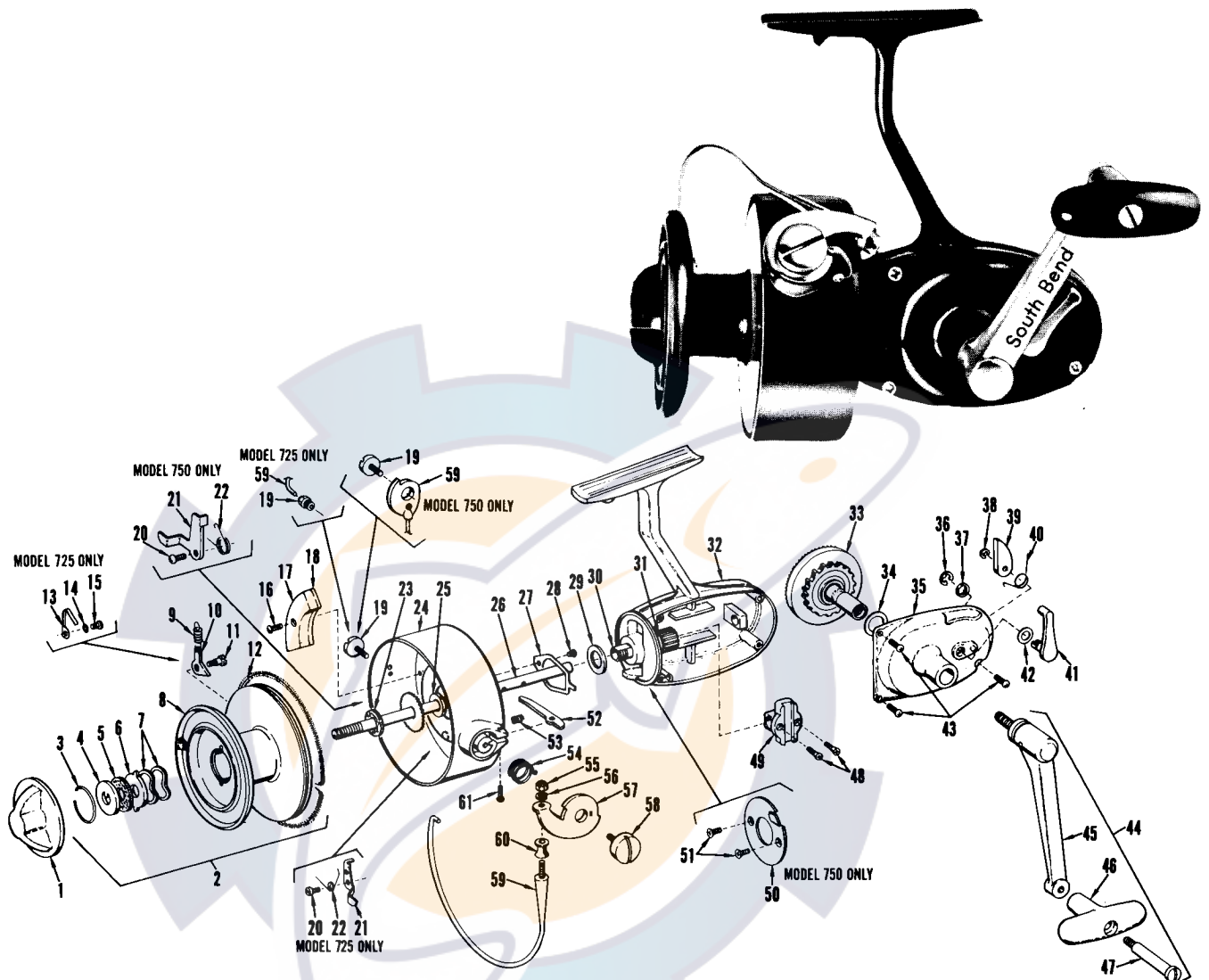

GLADDING
South Bend Tackle Co., Inc.
 Division of **GLADDING** Corporation

750
 3-200-750
SPINNING REEL



Detail No.	Part Name	Part No.	Price	Detail No.	Part Name	Part No.	Price
1	Drag Nut	SPC38	.85	33	Drive Gear	SPC98	1.15
2	Spool Assembly	SPC41	3.50	34	Drive Gear Washer	SPD2	.15
3	Retaining Ring	SPA89	.15	35	Cover Plate	SPD5	1.70
4	Keyed Drag Washer	SPA91	.15	36	Lever Retaining Ring	SPB96	.10
5	Leather Drag Washer	SPC46	.15	37	Non Reverse Cam Washer	SPD7	.10
6	Eared Drag Washer	SPA95	.15	38	Pawl Retaining Ring	SPB97	.10
7	Tension Washer	SPC49	.35	39	Non Reverse Pawl	SPB98	.20
9	Click Pawl Spring	SPB61	.20	40	Non Reverse Spring	SPB99	.15
10	Click Pawl	SPB62	.25	41	Non Reverse Lever	SPC2	.35
11	Click Pawl Screw	SPB63	.15	42	Lever Tension Washer	SPC1	.15
12	Line Guard	SPC57		43	Cover Plate Screws	SPC3	.10
16	Balance Weight Screw	SPC62	.10	44	Crank Assembly	SPD13	2.80
17	Balance Weight, lge.	SPC65	.40	45	Crank Arm	SPD16	1.00
19	Bail Retaining Screw	SPC34	.45	46	Crank Handle	SPC12	.55
20	Trip Lever Screw	SPB68	.10	47	Crank Handle Screw	SPC14	.40
21	Trip Lever	SPB60	.35	48	Bracket Screw	SPC15	.60
22	Trip Lever Spring	SPB69	.30	49	Level Wind Bracket	SPD24	.35
23	Spool Washer	SPB73	.10	50	Trip Plate	SPB84	.30
24	Pick-up Housing	SPC75	3.00	51	Trip Plate Screw	SPB82	.10
25	Pick-up Housing Nut	SPB75	.20	54	Bail Bracket Spring	SPC24	.30
26	Main Shaft	SPC79	.85	55	Line Roller Nut	SPC26	.20
27	Trip Spring	SPC82	.30	57	Bail Bracket	SPC22	.45
28	Trip Spring Screw	SPC85	.10	58	Bail Bracket Screw	SPC28	.60
29	Pinion Washer-Thick	SPB81	.15	59	Bail Wire	SPC32	1.50
30	Pinion Gear	SPC89	1.30	60	Line Roller	SPC30	.30
31	Pinion Washer, Thin	SPC92	.15	56	Lock Washer	SPC27	.10
32	Frame	SPC95	3.00				